

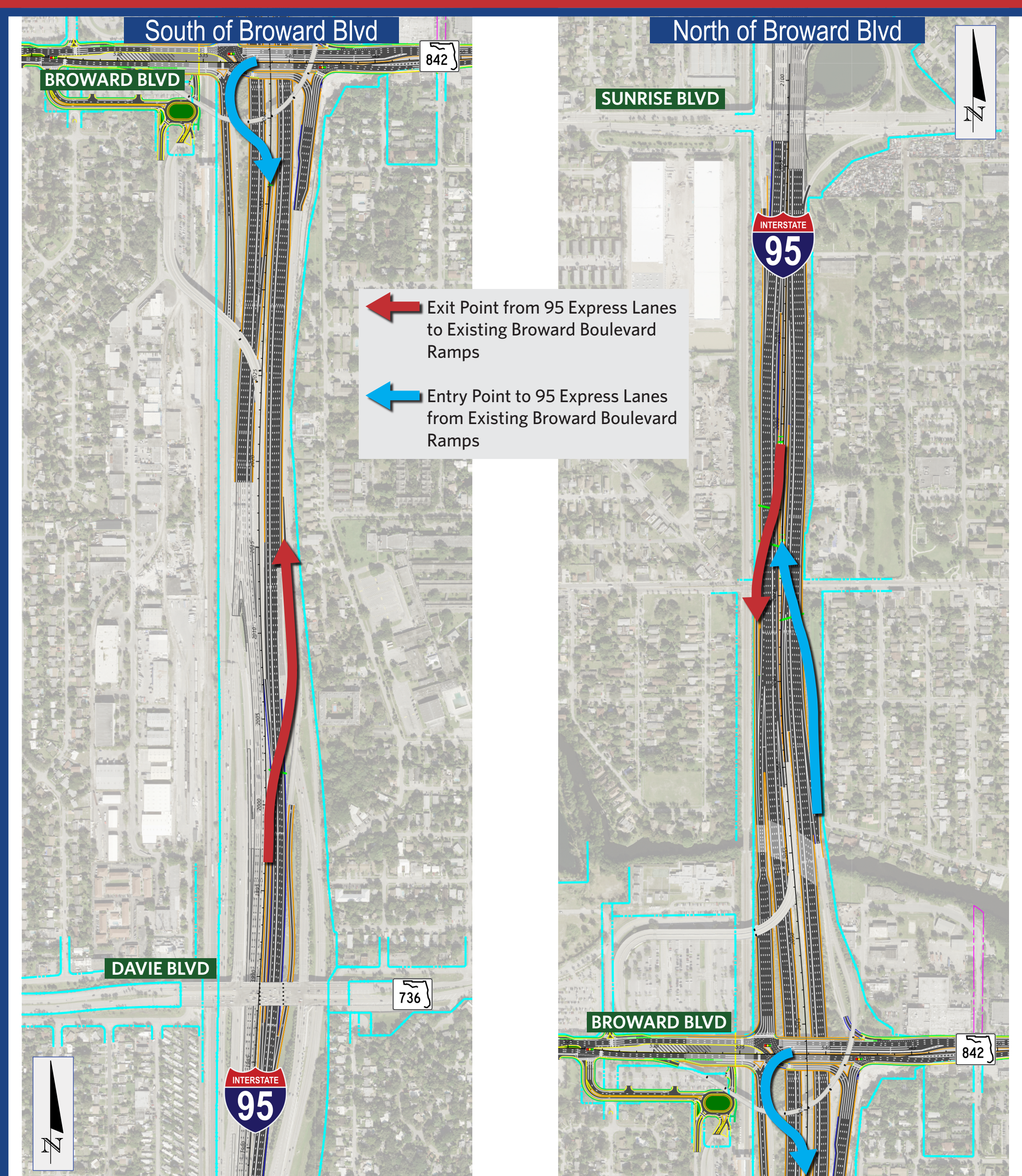

# Project Development & Environment (PD&E) Study

## I-95 at Broward Boulevard Interchange

### Broward County, Florida



95 Express Connectivity with Broward Boulevard



I-95 Northbound General Purpose Exit

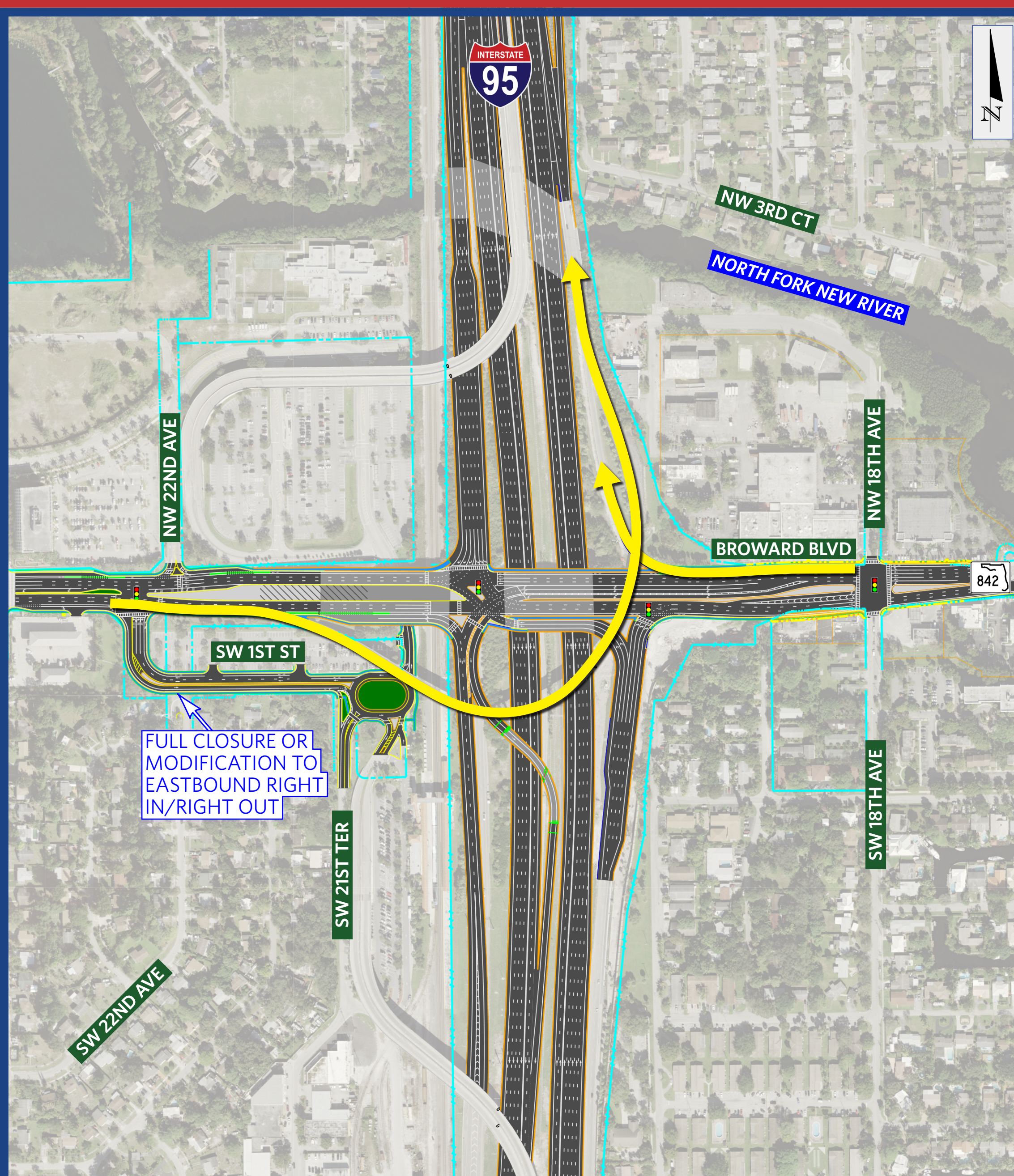

I-95 Northbound General Purpose Entrance



I-95 Southbound General Purpose Exit



Eastbound Broward Boulevard to Southbound I-95 Entrances

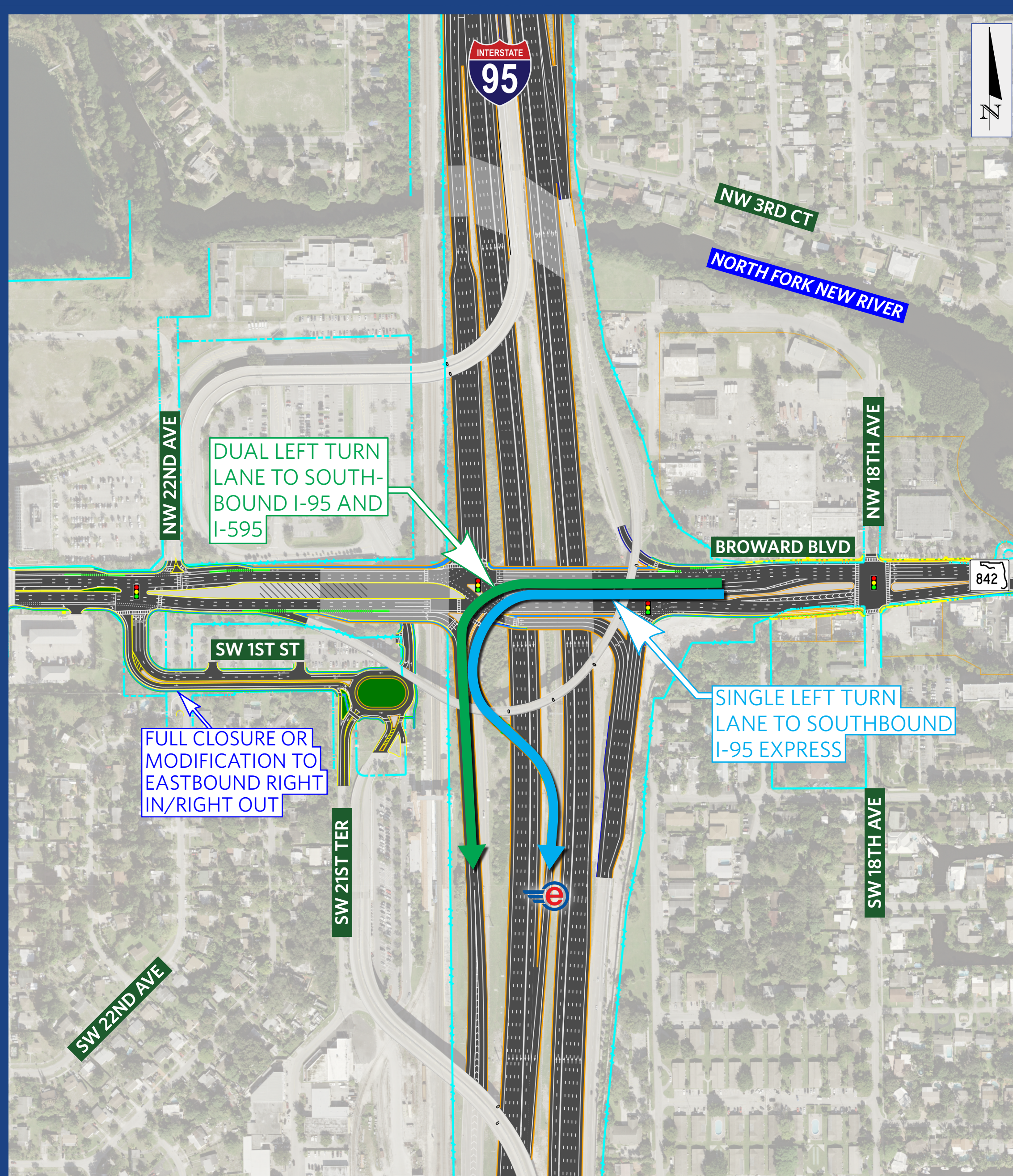

Westbound Broward Boulevard to Southbound I-95 Entrances

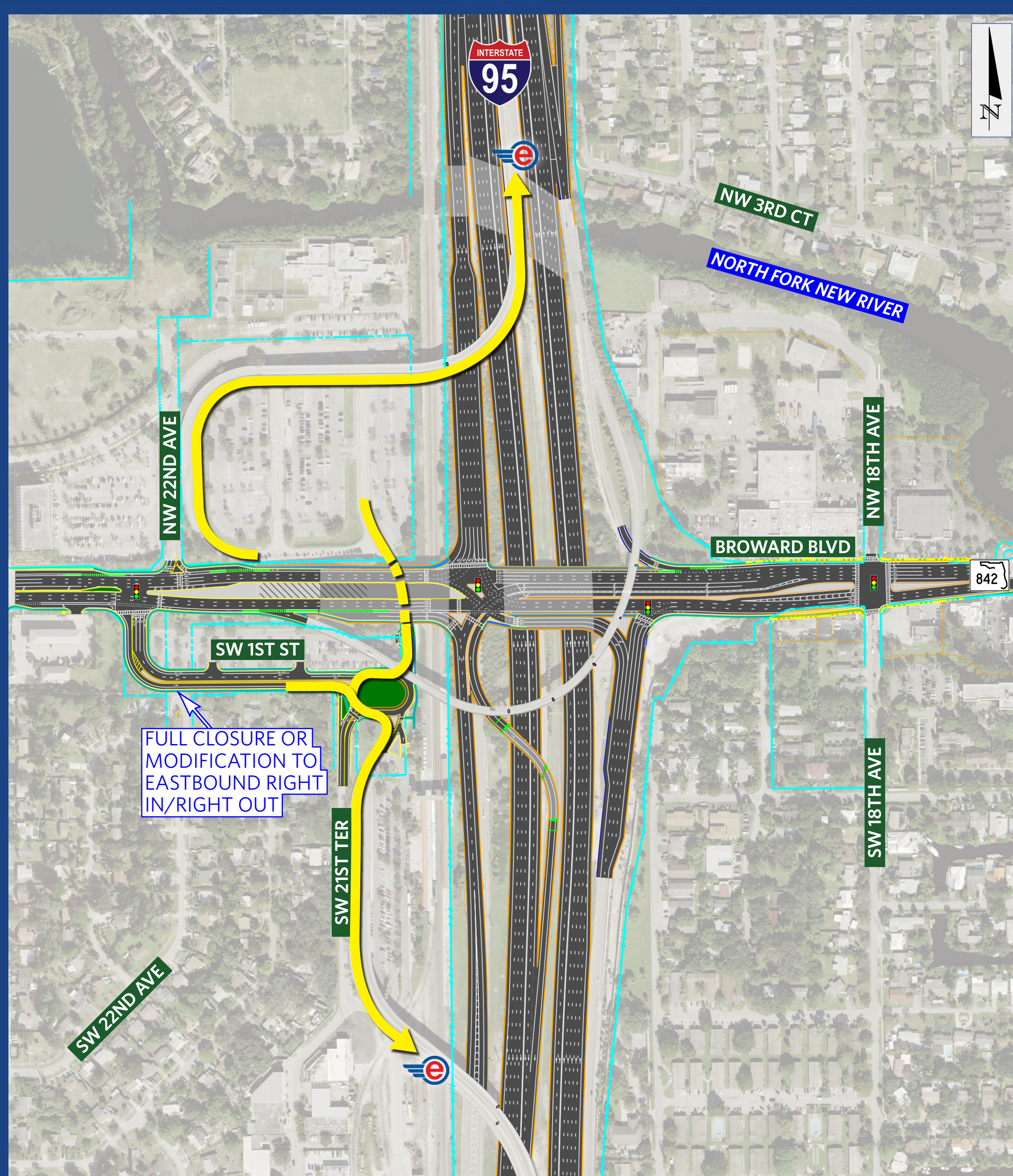

Park-and-Ride Lot/Transit Station to 95 Express Entrances

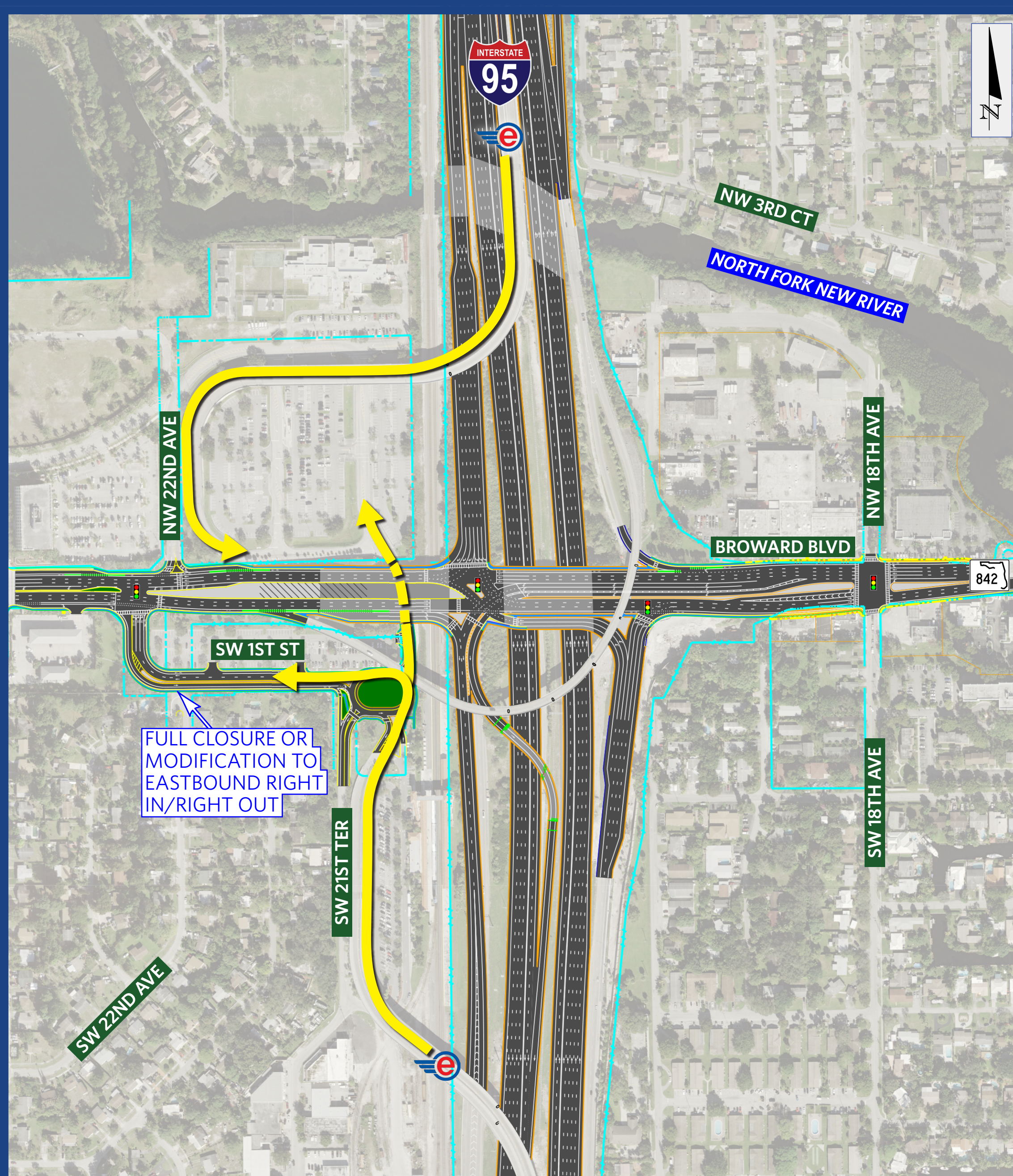

95 Express Exits to Park-and-Ride Lot/Transit Station

# Preferred Alternative Ingress/Egress and Interchange Traffic Movements

